

15 Check solenoid selector lock - criterion 15

The following work must only be carried out, if the vehicle is affected by criterion 15. See under ! Service Online /DOSYS/FISH.

Move the front seats to the rear and the front seat surfaces downwards.

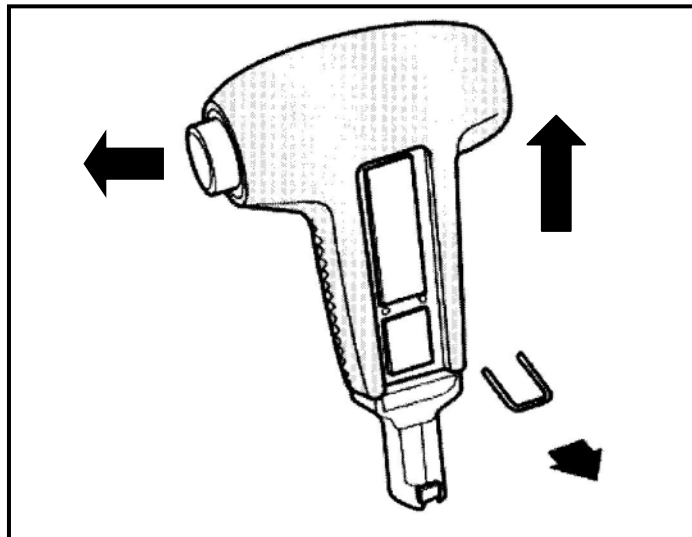

Remove the selector handle.

Move the selector to position "N", lever off the insert and pull out the retainer.

Pull the push-button to the left over the pressure point till it locks and carefully pull up the selector handle.

See under Phaeton (3D); Automatic gearbox; 37 Operation, housing; Remove and install selector handle, Remove and install selector mechanism, dismantle and assemble selector mechanism.

Pull the right side trim of the centre console by hand out of the clips and remove the electric connections under the panel for the gearshift.

Remove the panel for the gearshift with cover and carefully separate the shutter/cover strip from the cover.

Check whether the solenoid for the selector lock (arrows) has a washer.

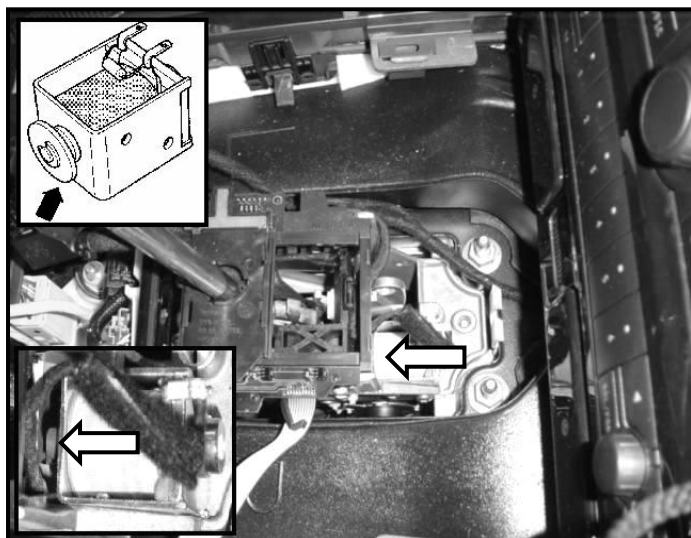

If the solenoid has a washer, no further work on the selector mechanism is necessary.

Install in reverse order.

If there is no washer on the solenoid, the solenoid must be replaced. Continue with point 15.1 "Replace solenoid selector lock".

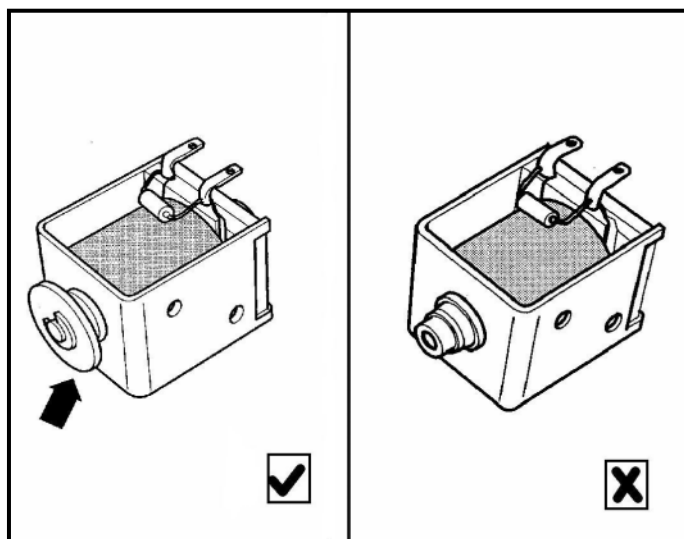
15.1 Replace solenoid selector lock**Note**

The following work is only necessary, if there is no washer on the solenoid of the selector lock.

Otherwise no further work on the selector mechanism is necessary.

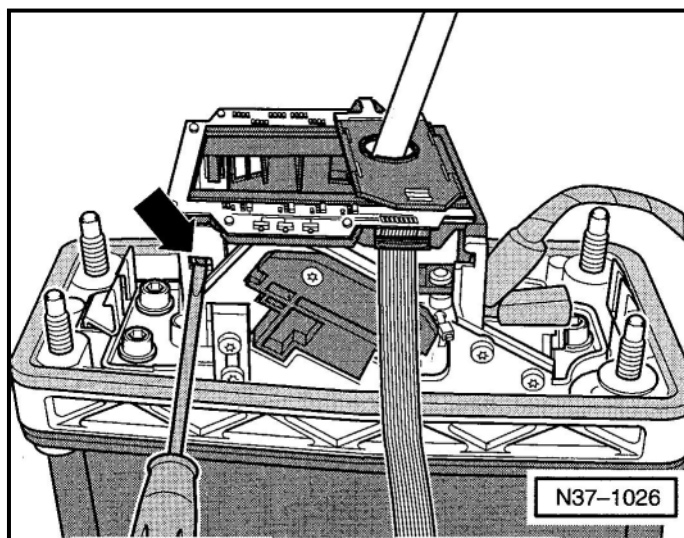
**Note.**

Make sure that no small parts/screws drop into the gearshift. Foreign bodies lead to functional problems and the complete gearshift mechanism would have to be removed.

Move the selector to position "R", unlock the frame for removal (arrow) and tip it upwards.

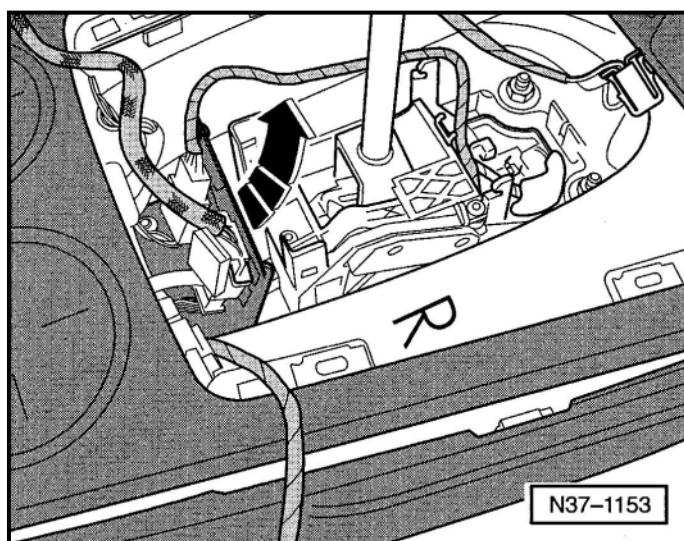

Take off the plug holder with plug and remove the two plugs from the solenoid.

Note.

Mark the position of the individual plugs.

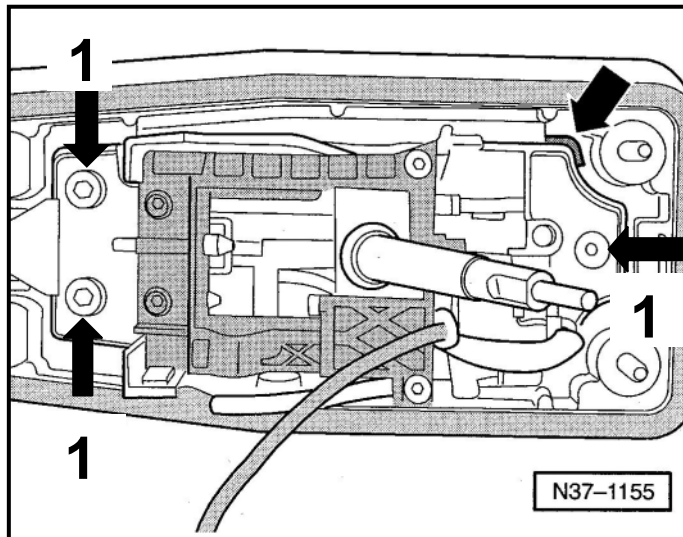

Mark the position of the selector mechanism (arrow) with a scribe.

Note

Do not fully unscrew the bolts (1) but loosen them only by a maximum of 5 turns.

The selector mechanism is now loose enough for it to be carefully lifted/tilted to the left.

At the front in the footwell the right side trim of the centre console is held by a screw. Take it off and carefully press the side trim to one side.

See under Phaeton (3D); Body; Interior body repairs; 68 Interior equipment; Shelves, covers and trims; Remove and install centre console.

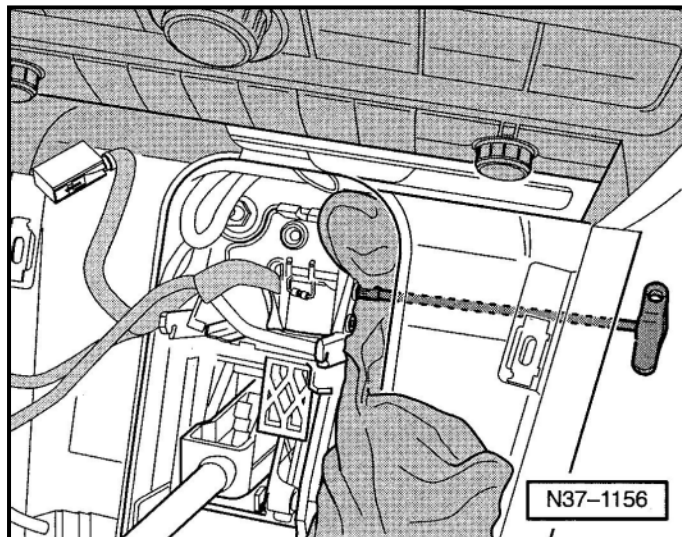

Put a clean cloth between gearshift and centre console to prevent the screws of the solenoid switch from falling into the gearshift.

Unscrew first the lower and then the upper screw of the solenoid and replace the solenoid.

The screws don't necessarily have to be taken out of the bore holes.

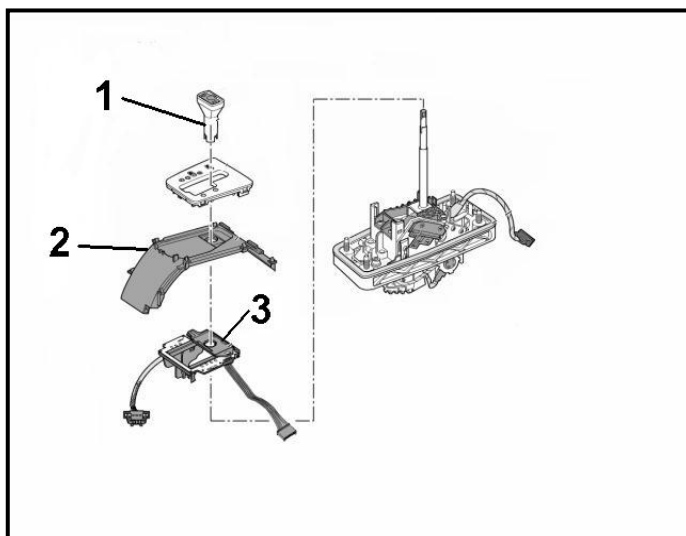

Install in reverse order.

Note

Make sure on the insert of the gear lever sleeve (1) that the hole in the shutter/cover strip (2) is exactly flush with the hole in the frame/cross slide (3) of the printed circuit.

Otherwise the frame may get damaged during the installation.

Tightening torques

Screws for solenoid

1.4 Nm

Screws (1) for selector mechanism on body

20 Nm

Note.

After tightening the selector mechanism check the adjustment of the selector cable.

See under Phaeton (3D); Automatic gearbox; 37 Operation, housing; Repair selector mechanism, check and adjust selector cable.

--